

Aug. 19 1905

Measurements of finished cement  
 Walk on 23<sup>rd</sup> St. to  
 Wheelwright Bldg. Contractors }  
 G. K. P. Inst }  
 H. B. S. Prod. }  
 G. S. P. Chan } 80m to 12m  
 Floyd Inspector }

Lincoln Ave.

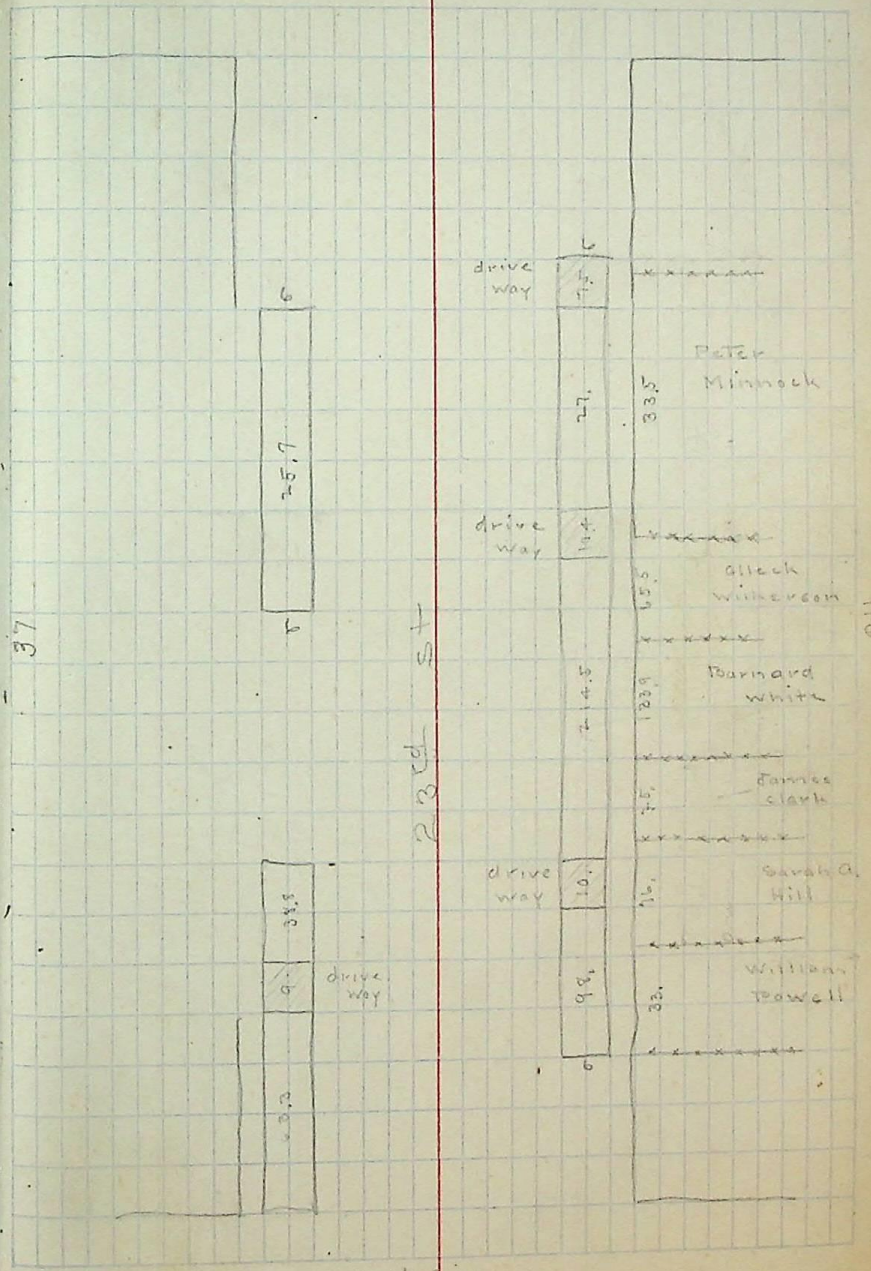

Wall Ave.